

FORM NO 1.

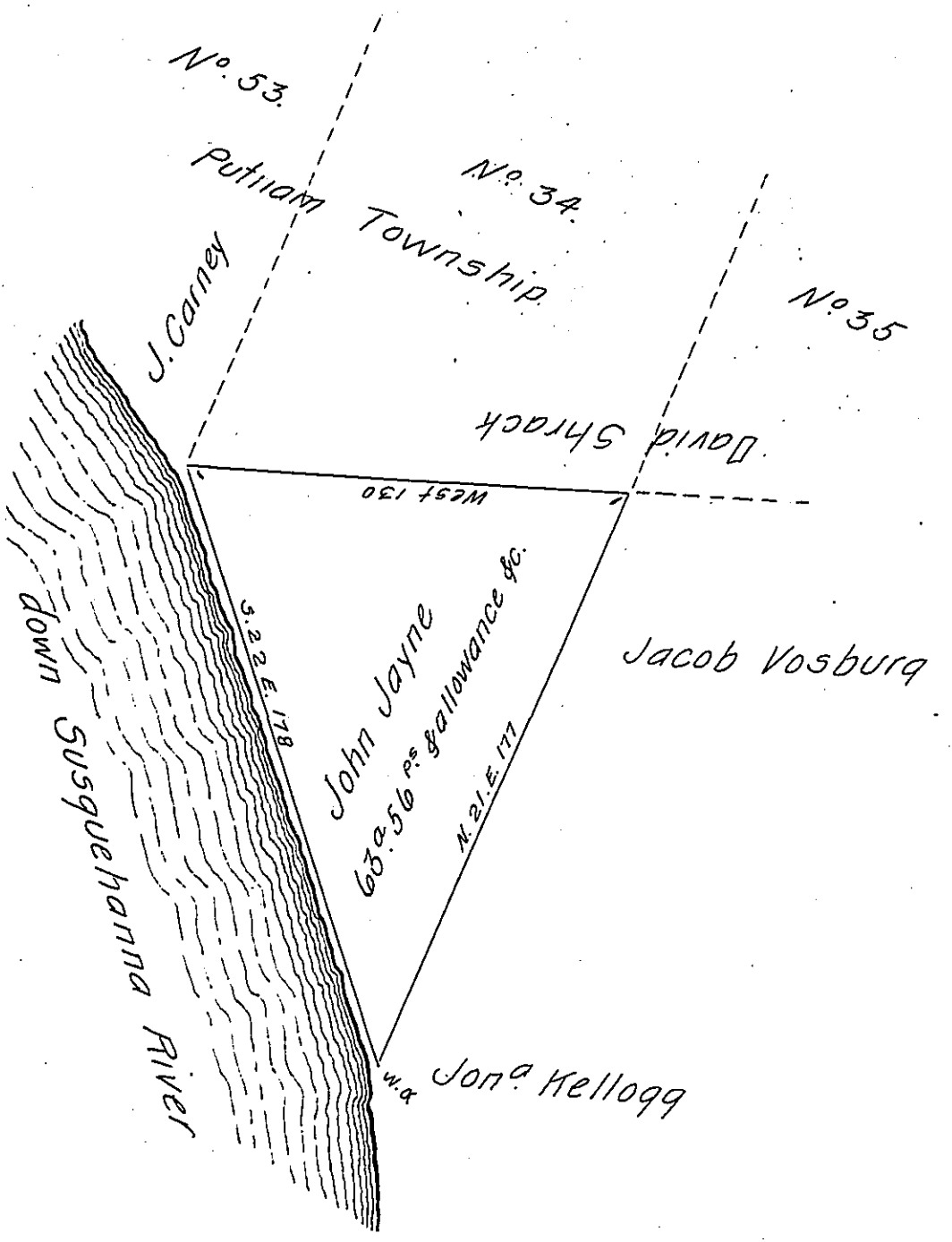

Draught of a tract of Land Situate in the townships of Tunkh^o & Braintrim formerly the township of Putnam one of the 17 townships in Luzerne County containing Sixty three acres and fifty Six perches of land besides the usual allowance &c. Surveyed the 8th day of October A^o D^o 1828. by John Bennet Esq^r D.S. my predecessor in Office for John Jayne. by virtue of his Warrant dated the 6th of May 1828. - and returned by me this 14th day of March A. D. 1833.

To Jacob Spangler Esq^r }
 Surveyor General } Henry Colt D.S.

IN TESTIMONY that the above is a copy of the original remaining on file in the Department of Internal Affairs of Pennsylvania, made conformably to an Act of Assembly approved the 16th day of February, 1833, I have hereunto set my Hand and caused the Seal of said Department to be affixed at Harrisburg, this twenty first day of January 1908.

Henry Howell
 Secretary of Internal Affairs.